



Lift King 4-Post Triple Stacker

- **Easy 'push-button' operation...**
- **Double safety locks incorporating slack cable system**
- **Galvanised waveplates between runways - prevent drips on lower vehicles...**
 - **Foldable ramps - suitable for sports cars - occupy less space**
 - **Wheel stoppers on upper platform...**
- **Photo-sensor - to ensure lowering of platform cannot occur if a vehicle is detected...**
 - **Separate operation box for each lift placed on front right post...**
 - **CE Certified according to EC machinery directive 2006/42/CE**
- **2 separated 4-posters installed together; 1 internal and 1 external**
 - **Hydraulically driven cylinder with steel cables / sheaves**
 - **Auto locking latches with electro-magnetic lock release**
 - **Electric control panel & motor of external lift placed inside a compartment fixed to rear side of its platform**
- **Electric control panel & motor of internal lift placed behind its post**
 - **Steel components are sand-blasted then anti corrosion primer painted & top finish colour coated...**



Product parameters	
(Lifting Height)	1800/3500 mm
(Lifting Capacity)	2700 kg / platform, and 5400 kg totally
(Platform size)	Lower : 4198 x 1966 mm & Upper : 4780 x 1966 mm
(External Dimension)	6575 *2752*4065 mm
(Middle between runway)	Galvanized steel wave plates / diamond plates
(Operation Mode)	Push buttons on operation box
(Lock release type)	Electromagnetic lock release
(Safety Devices)	One piece adjustable safety lock ladder and the other is activated automatically in case of steel wire rupture
(Rise/Drop Time/Lifting Speed)	60 S / 50 S
(Power Supply / Motor Capacity)	220 V / 380 V , 50 Hz / 60 Hz , 1 Ph / 3 Ph, 2.2 Kw

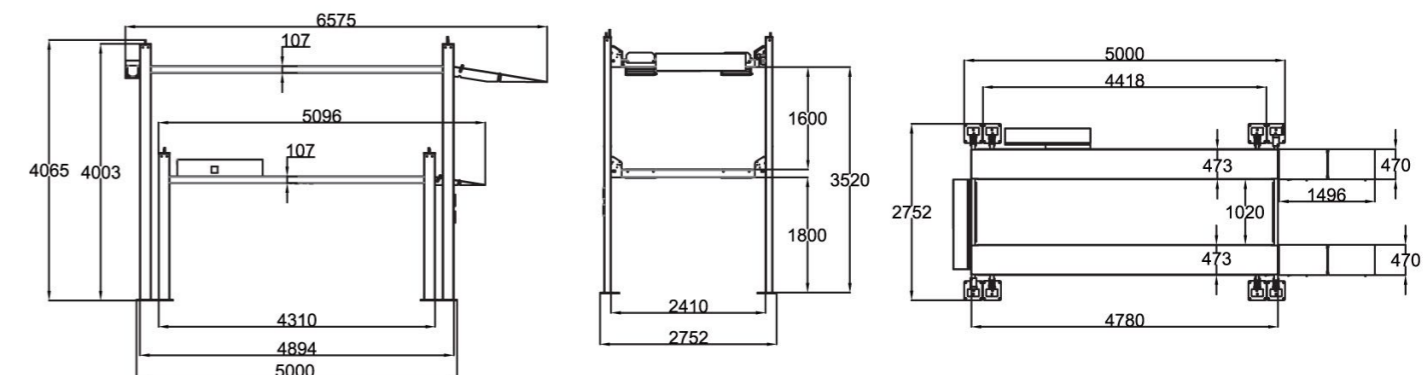

www.herohoists.com.au
1300 79 LIFT

